

**Deep groove ball bearings
(metric sizes)**

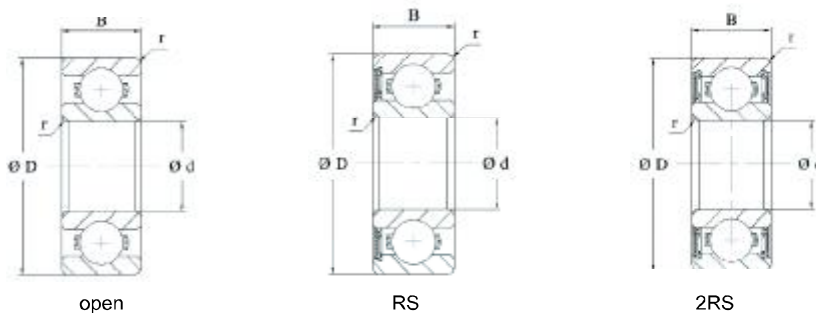

Shaft diameter	Dimensions				Load rating		Limiting speed	Code bearing	Mass
	d	D	B	$r_{s \min}$	dyn. C	stat. Co			
	mm				kN		min^{-1}	HMEC	≈ kg
35	35	55	10	0.6	10.60	7.25	12000	6907.ZZ	0.075
	35	55	10	0.6	10.60	7.25	7500	6907.2RS	0.075
	35	62	9	0.3	12.2	8.8	14000	16007	0.105
	35	62	14	1	16	10.2	28000	6007	0.157
	35	62	14	1	16	10.2	11000	6007.ZZ	0.163
	35	62	14	1	16	10.2	7500	6007.2RS	0.163
	35	72	17	1.1	25.5	15.3	24000	6207	0.291
	35	72	17	1.1	25.5	15.3	9500	6207.ZZ	0.299
	35	72	17	1.1	25.5	15.3	6300	6207.2RS	0.301
	35	72	23	1.1	25.5	15.3	6300	62207.2RS	0.393
	35	80	21	1.5	33.5	19	20000	6307	0.471
	35	80	21	1.5	33.5	19	8500	6307.ZZ	0.481
35	80	21	1.5	33.5	19	5600	6307.2RS	0.483	
35	80	31	1.5	33.5	19	5600	62307.2RS	0.687	
35	100	25	1.5	53	31.5	16000	6407	0.971	
40	40	52	7	0.3	4.90	4.35	14000	6808	0.031
	40	52	7	0.3	4.90	4.35	12000	6808.ZZ	0.031
	40	52	7	0.3	4.90	4.35	6700	6808.2RS	0.031
	40	62	12	0.6	13.70	10.00	13000	6908	0.112
	40	62	12	0.6	13.70	10.00	11000	6908.ZZ	0.112