

Cylindrical roller bearings

Series **N..**
NU..
NJ..
NUP..

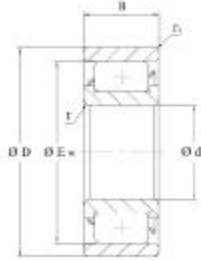

N

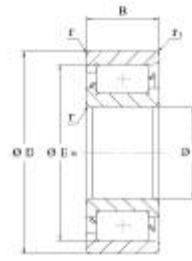

NUP

Shaft diameter	Dimensions					Load rating		Speed rating		Code bearing	Mass
	d	D	B	r ₁ , r ₂ min	r ₃ , r ₄ min	dyn. C _r	stat. C _{or}	ng _{grease}	ng _{oil}	HMEC	≈
	mm					kN		rpm			kg
200	200	360	58	4	4	750	1040	1600	1900	NU 240 E.M	26.9
	200	360	58	4	4	750	1040	1600	1900	NJ 240 E.M	26.9
	200	360	58	4	4	750	1040	1600	1900	NUP 240 E.M	26.9
	200	360	98	4	4	1220	1860	1500	1800	NU 2240 E.M	45.7
	200	360	98	4	4	1220	1860	1500	1800	NJ 2240 E.M	45.7
	200	420	80	5	5	965	1250	1400	1700	NU 340 M	57.5
	200	420	80	5	5	965	1250	1400	1700	NJ 340 M	57.5
	200	420	138	5	5	1500	2200	1300	1600	NU 2340 M	99
	200	420	138	5	5	1500	2200	1300	1600	NJ 2340 M	99
220	220	340	56	3	3	510	765	1700	2000	NU 1044 M	19.3
	220	400	65	4	4	750	1060	1500	1800	NU 244 M	38.1
	220	400	65	4	4	750	1060	1500	1800	NJ 244 M	38.1
	220	400	65	4	4	750	1060	1500	1800	NUP 244 M	38.1
	220	400	108	4	4	1120	1800	1400	1700	NU 2244 M	63.5
	220	400	108	4	4	1120	1800	1400	1700	NJ 2244 M	63.5
	220	460	88	5	5	1180	1560	1300	1600	NU 344 M	75.5
	220	460	145	5	5	1760	2600	1200	1500	NU 2344 E	124
	240	240	360	56	3	3	540	850	1600	1900	NU 1048 M
240		440	72	4	4	930	1340	1300	1600	NU 248 M	51.5
240		440	72	4	4	930	1340	1300	1600	NJ 248 M	51.5