

Cylindrical roller bearings

Series **N..**
NU..
NJ..
NUP..

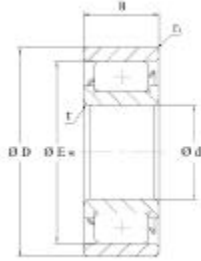

N

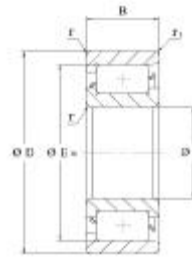

NUP

Shaft diameter	Dimensions					Load rating		Speed rating		Code bearing	Mass
	d	D	B	r _{1, r₂} min	r _{3, r₄} min	dyn. C _r	stat. C _{or}	ng _{grease}	ng _{oil}	HMEC	≈
	mm					kN		rpm			kg
130	130	230	40	3	3	360	450	2400	3000	NUP 226 E	6.5
	130	230	64	3	3	530	735	2400	3000	NU 2226 E	10.5
	130	230	64	3	3	530	735	2400	3000	NJ 2226 E	10.5
	130	230	64	3	3	530	735	2400	3000	NUP 2226 E	10.5
	130	280	58	4	4	570	670	2000	2600	N 326 E	16.5
	130	280	58	4	4	570	670	2000	2600	NU 326 E	16.5
	130	280	58	4	4	570	670	2000	2600	NJ 326 E	16.5
	130	280	58	4	4	570	670	2000	2600	NUP 326 E	16.5
	130	280	93	4	4	915	1220	1900	2400	NU 2326 E.M	29.6
	130	280	93	4	4	915	1220	1900	2400	NJ 2326 E.M	29.6
	130	280	93	4	4	915	1220	1900	2400	NUP 2326 E.M	29.6
	130	340	78	6	5	790	960	1800	2200	NU 426 M	42.6
	130	340	78	6	5	790	960	1800	2200	NJ 426 M	42.6
140	140	210	33	2	1.1	183	265	2800	3400	NU 1028 M	4.1
	140	250	42	3	3	390	510	2400	3000	N 228 E.M	9.5
	140	250	42	3	3	390	510	2400	3000	NU 228 E.M	9.5
	140	250	42	3	3	390	510	2400	3000	NJ 228 E.M	9.5
	140	250	42	3	3	390	510	2400	3000	NUP 228 E.M	9.5
	140	250	68	3	3	570	830	2200	2800	NU 2228 E.M	15.5
	140	250	68	3	3	570	830	2200	2800	NJ 2228 E.M	15.5
	140	250	68	3	3	570	830	2200	2800	NUP 2228 E.M	15.5
	140	300	62	4	4	670	800	1900	2400	N 328 E	22.5
	140	300	62	4	4	670	800	1900	2400	NU 328 E	22.5
	140	300	62	4	4	670	800	1900	2400	NJ 328 E	22.5
	140	300	62	4	4	670	800	1900	2400	NUP 328 E	22.5
	140	300	102	4	4	1020	1400	1800	2200	NU 2328 E.M	37.2
	140	300	102	4	4	1020	1400	1800	2200	NJ 2328 E.M	37.2
	140	300	102	4	4	1020	1400	1800	2200	NUP 2328 E.M	37.2