

Cylindrical roller bearings

Series **N..**
NU..
NJ..
NUP..

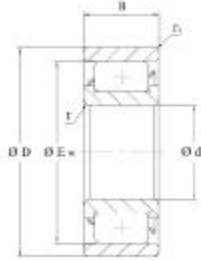

N

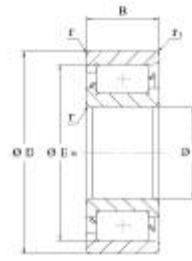

NUP

Shaft diameter	Dimensions					Load rating		Speed rating		Code bearing	Mass
	d	D	B	r _{1, r₂} min	r _{3, r₄} min	dyn. C _r	stat. C _{or}	n _g grease	n _g oil	HMEC	≈
	mm					kN		rpm			kg
75	75	115	20	1.1	1	65.5	85	5300	6300	NU 1015 M	0.75
	75	130	25	1.5	1.5	132	156	4500	5300	N 215 E	1.25
	75	130	25	1.5	1.5	132	156	4500	5300	NU 215 E	1.25
	75	130	25	1.5	1.5	132	156	4500	5300	NJ 215 E	1.25
	75	130	25	1.5	1.5	132	156	4500	5300	NUP 215 E	1.25
	75	130	31	1.5	1.5	163	208	4500	5300	NU 2215 E	1.6
	75	130	31	1.5	1.5	163	208	4500	5300	NJ 2215 E	1.6
	75	130	31	1.5	1.5	163	208	4500	5300	NUP 2215 E	1.6
	75	160	37	2.1	2.1	240	265	3400	4000	N 315 E	3.4
	75	160	37	2.1	2.1	240	265	3400	4000	NU 315 E	3.4
	75	160	37	2.1	2.1	240	265	3400	4000	NJ 315 E	3.4
	75	160	37	2.1	2.1	240	265	3400	4000	NUP 315 E	3.4
	75	160	55	2.1	2.1	325	390	3400	4000	NU 2315 E	5.0
	75	160	55	2.1	2.1	325	390	3400	4000	NJ 2315 E	5.0
	75	160	55	2.1	2.1	325	390	3400	4000	NUP 2315 E	5.0
	75	190	45	3	3	260	270	3200	3800	N 415 M	6.45
	75	190	45	3	3	260	270	3200	3800	NU 415 M	6.45
75	190	45	3	3	260	270	3200	3800	NJ 415 M	6.45	
75	190	45	3	3	260	270	3200	3800	NUP 415 M	6.45	
80	80	125	22	1.1	1	76.5	98	5000	6000	NU 1016 M	1.03
	80	140	26	2	2	140	170	4000	4800	N 216 E	1.54
	80	140	26	2	2	140	170	4000	4800	NU 216 E	1.54
	80	140	26	2	2	140	170	4000	4800	NJ 216 E	1.54
	80	140	26	2	2	140	170	4000	4800	NUP 216 E	1.54
	80	140	33	2	2	186	245	4000	4800	NU 2216 E	2.1
	80	140	33	2	2	186	245	4000	4800	NJ 2216 E	2.1
	80	140	33	2	2	186	245	4000	4800	NUP 2216 E	2.1
	80	170	39	2.1	2.1	255	275	3200	3800	N 316 E	3.95