

Cylindrical roller bearings

Series **N..**
NU..
NJ..
NUP..

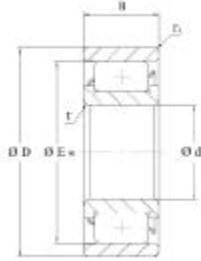

N

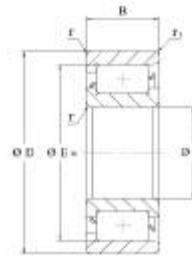

NUP

Shaft diameter	Dimensions					Load rating		Speed rating		Code bearing	Mass	
	d	D	B	r _{1, r₂} _{min}	r _{3, r₄} _{min}	dyn. C _r	stat. C _{or}	ng _{grease}	ng _{oil}	HMEC	≈	
	mm					kN		rpm			kg	
45	45	85	23	1.1	1.1	73.5	81.5	7000	8500	NU 2209 E	0.6	
	45	85	23	1.1	1.1	73.5	81.5	7000	8500	NJ 2209 E	0.6	
	45	85	23	1.1	1.1	73.5	81.5	7000	8500	NUP 2209 E	0.6	
	45	100	25	1.5	1.5	98	100	5600	6700	N 309 E	1	
	45	100	25	1.5	1.5	98	100	5600	6700	NU 309 E	1	
	45	100	25	1.5	1.5	98	100	5600	6700	NJ 309 E	1	
	45	100	25	1.5	1.5	98	100	5600	6700	NUP 309 E	1	
	45	100	36	1.5	1.5	137	153	5600	6700	NU 2309 E	1.3	
	45	100	36	1.5	1.5	137	153	5600	6700	NJ 2309 E	1.3	
	45	100	36	1.5	1.5	137	153	6700	6000	NUP 2309 E	1.3	
	45	120	29	2	2	106	100	5000	6000	N 409 M	1.7	
	45	120	29	2	2	106	100	5000	6000	NU 409 M	1.7	
	45	120	29	2	2	106	100	5000	6000	NJ 409 M	1.7	
	45	120	29	2	2	106	100	5000	6000	NUP 409 M	1.7	
	50	50	80	16	1	0.6	36	41.5	8000	9500	NU 1010 M	0.32
		50	90	20	1.1	1.1	64	68	6700	8000	N 210 E	0.6
50		90	20	1.1	1.1	64	68	6700	8000	NU 210 E	0.6	
50		90	20	1.1	1.1	64	68	6700	8000	NJ 210 E	0.6	
50		90	20	1.1	1.1	64	68	6700	8000	NUP 210 E	0.6	
50		90	23	1.1	1.1	78	88	6700	8000	NU 2210 E	0.65	
50		90	23	1.1	1.1	78	88	6700	8000	NJ 2210 E	0.65	
50		90	23	1.1	1.1	78	88	6700	8000	NUP 2210 E	0.65	
50		110	27	2	2	110	114	5300	6300	N 310 E	1.2	
50		110	27	2	2	110	114	5300	6300	NU 310 E	1.2	
50		110	27	2	2	110	114	5300	6300	NJ 310 E	1.2	
50		110	27	2	2	110	114	5300	6300	NUP 310 E	1.2	
50		110	40	2	2	163	186	5300	6300	NU 2310 E	1.9	
50		110	40	2	2	163	186	5300	6300	NJ 2310 E	1.9	