

## Cylindrical roller bearings

Series **N..**  
**NU..**  
**NJ..**  
**NUP..**

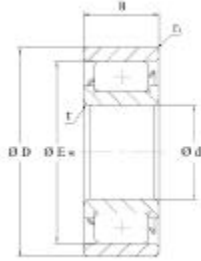

N

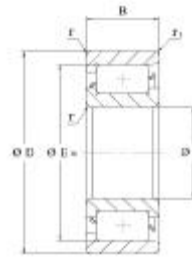

NUP

Shaft diameter	Dimensions					Load rating		Speed rating		Code bearing	Mass
	d	D	B	r <sub>1</sub> , r <sub>2</sub> min	r <sub>3</sub> , r <sub>4</sub> min	dyn. C <sub>r</sub>	stat. C <sub>or</sub>	n <sub>g</sub> grease	n <sub>g</sub> oil	HMEC	≈
	mm					kN		rpm			kg
15	15	35	11	0.6	0.3	12.7	10.4	18000	22000	<b>N 202 E</b>	0.047
	15	35	11	0.6	0.3	12.7	10.4	18000	22000	<b>NU 202 E</b>	0.047
	15	35	11	0.6	0.3	12.7	10.4	18000	22000	<b>NJ 202 E</b>	0.047
17	17	40	12	0.6	0.3	17.6	14.6	15000	18000	<b>N 203 E</b>	0.068
	17	40	12	0.6	0.3	17.6	14.6	15000	18000	<b>NU 203 E</b>	0.068
	17	40	12	0.6	0.3	17.6	14.6	15000	18000	<b>NJ 203 E</b>	0.068
	17	40	12	0.6	0.3	17.6	14.6	15000	18000	<b>NUP 203 E</b>	0.068
	17	40	16	0.6	0.3	24	22	15000	18000	<b>NU 2203 E</b>	0.091
	17	40	16	0.6	0.3	24	22	15000	18000	<b>NJ 2203 E</b>	0.091
	17	40	16	0.6	0.3	24	22	15000	18000	<b>NUP 2203 E</b>	0.091
	17	47	14	1.1	0.6	25.5	21.2	13000	16000	<b>NU 303 E</b>	0.120
	17	47	14	1.1	0.6	25.5	21.2	13000	16000	<b>NJ 303 E</b>	0.120
17	47	14	1.1	0.6	25.5	21.2	13000	16000	<b>NUP 303 E</b>	0.120	
20	20	47	14	1	0.6	27.5	24.5	13000	16000	<b>N 204 E</b>	0.132
	20	47	14	1	0.6	27.5	24.5	13000	16000	<b>NU 204 E</b>	0.132
	20	47	14	1	0.6	27.5	24.5	13000	16000	<b>NJ 204 E</b>	0.132
	20	47	14	1	0.6	27.5	24.5	13000	16000	<b>NUP 204 E</b>	0.132
	20	47	18	1	0.6	32.5	31	13000	16000	<b>NU 2204 E</b>	0.142
	20	47	18	1	0.6	32.5	31	13000	16000	<b>NJ 2204 E</b>	0.142
	20	47	18	1	0.6	32.5	31	13000	16000	<b>NUP 2204 E</b>	0.142
	20	52	15	1	0.6	31.5	27	11000	14000	<b>N 304 E</b>	0.151
	20	52	15	1	0.6	31.5	27	11000	14000	<b>NU 304 E</b>	0.151
	20	52	15	1	0.6	31.5	27	11000	14000	<b>NJ 304 E</b>	0.151
	20	52	15	1.1	0.6	31.5	27	11000	14000	<b>NUP 304 E</b>	0.150
	20	52	21	1.1	0.6	41.5	39	11000	14000	<b>NU 2304 E</b>	0.210
	20	52	21	1.1	0.6	41.5	39	11000	14000	<b>NJ 2304 E</b>	0.210