

Adapter Sleeves

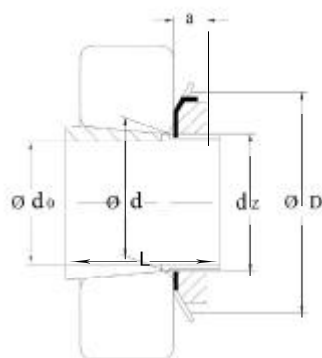

Dimensions						Code	Appropriate Components		Weight
d_0	d	d_2	D	L	a	HMEC	Nut	Locking	
mm						Sleeve incl Nut and Locking			\approx kg
100	110	M110x2	145	81	21	H3122	KM22	MB22	2.250
100	110	M110x2	145	77	21	H222	KM22	MB22	1.930
100	110	M110x2	145	105	21	H322	KM22	MB22	2.180
100	110	M110x2	145	105	21	H2322	KM22	MB22	2.740
110	120	M120x2	145	72	22	H3024	KML24	MBL24	1.9630
110	120	M120x2	155	88	22	H3124	KM24	MB24	2.640
110	120	M120x2	155	112	22	H2324	KM24	MB24	3.190
115	130	M130x2	155	80	23	H3026	KML26	MBL26	2.850
115	130	M130x2	165	92	23	H3126	KM26	MB26	3.660
115	130	M130x2	165	121	23	H2326	KM26	MB26	4.600
125	140	M140x2	165	82	24	H3028	KML28	MBL28	3.160
125	140	M140x2	180	97	24	H3128	KM28	MB28	4.340
125	140	M140x2	180	131	24	H2328	KM28	MB28	5.550
135	150	M150x2	180	87	26	H3030	KML30	MBL30	3.890
135	150	M150x2	195	111	26	H3130	KM30	MB30	5.520
135	150	M150x2	195	139	26	H2330	KM30	MB30	6.630
140	160	M160x3	190	93	28	H3032	KML32	MBL32	5.210
140	160	M160x3	210	119	28	H3132	KM32	MB32	7.670
140	160	M160x3	210	147	28	H2332	KM32	MB32	9.140
150	170	M170x3	200	101	29	H3034	KML34	MBL34	5.990
150	170	M170x3	220	122	29	H3134	KM34	MB34	8.360
150	170	M170x3	220	154	29	H2334	KM34	MB34	10.200
160	180	M180x3	210	109	30	H3036	KML36	MBL36	6.830