

## HMEC

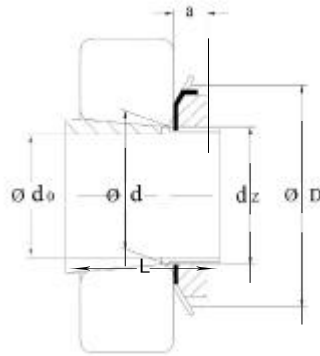

Dimensions						Code	Appropriate		Weight
$d_0$	$d$	$d_2$	D	L	$a$	HMEC	Nut	Locking	
mm						Sleeve incl Nut and Locking			≈ kg
55	60	M60x2	80	62	13	<b>H2312</b>	KM12	MB12	0.481
60	65	M65x2	85	40	14	<b>H213</b>	KM13	MB13	0.401
60	65	M65x2	85	50	14	<b>H313</b>	KM13	MB13	0.557
60	65	M65x2	85	65	14	<b>H2313</b>	KM13	MB13	0.557
65	75	M75x2	98	43	15	<b>H215</b>	KM15	MB15	0.707
65	75	M75x2	98	55	15	<b>H315</b>	KM15	MB15	0.831
65	75	M75x2	98	73	15	<b>H2315</b>	KM15	MB15	1.050
70	80	M80x2	105	46	17	<b>H216</b>	KM16	MB16	0.882
70	80	M80x2	105	59	17	<b>H316</b>	KM16	MB16	1.030
70	80	M80x2	105	78	17	<b>H2316</b>	KM16	MB16	1.280
75	85	M85x2	110	50	18	<b>H217</b>	KM17	MB17	1.020
75	85	M85x2	110	63	18	<b>H317</b>	KM17	MB17	1.180
75	85	M85x2	110	82	18	<b>H2317</b>	KM17	MB17	1.450
80	90	M90x2	120	62	18	<b>H218</b>	KM18	MB18	1.190
80	90	M90x2	120	65	18	<b>H318</b>	KM18	MB18	1.370
80	90	M90x2	120	86	18	<b>H2318</b>	KM18	MB18	1.690
85	95	M95x2	125	55	19	<b>H219</b>	KM19	MB19	1.370
85	95	M95x2	125	68	19	<b>H319</b>	KM19	MB19	1.560
85	95	M95x2	125	90	19	<b>H2319</b>	KM19	MB19	1.920
90	100	M100x2	130	58	20	<b>H220</b>	KM20	MB20	1.490
90	100	M100x2	130	71	20	<b>H320</b>	KM20	MB20	1.690
90	100	M100x2	130	97	20	<b>H2320</b>	KM20	MB20	2.150