

## HMEC

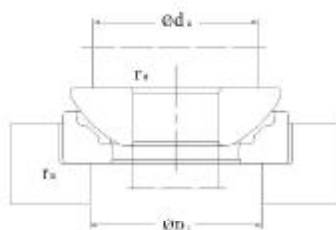

| principal dimensions |     |      | Angle of tilt<br>$\alpha$ | Basic load ratings |                 | Code bearing<br>HMEC | Mass<br>$\approx$<br>kg |
|----------------------|-----|------|---------------------------|--------------------|-----------------|----------------------|-------------------------|
| d                    | D   | T    |                           | Dynamic<br>C       | Static<br>$C_0$ |                      |                         |
| mm                   |     |      |                           | N                  |                 |                      |                         |
| 17                   | 47  | 16   | 5                         | 36500              | 58500           | <b>GX17F</b>         | 0.14                    |
| 20                   | 55  | 20   | 5                         | 46500              | 73500           | <b>GX20F</b>         | 0.25                    |
| 25                   | 62  | 22.5 | 5                         | 69500              | 112000          | <b>GX25F</b>         | 0.42                    |
| 30                   | 75  | 26   | 5                         | 95000              | 153000          | <b>GX30F</b>         | 0.61                    |
| 35                   | 90  | 28   | 6                         | 134000             | 216000          | <b>GX35F</b>         | 0.98                    |
| 40                   | 105 | 32   | 6                         | 173000             | 275000          | <b>GX40F</b>         | 1.50                    |
| 45                   | 120 | 36.5 | 6                         | 224000             | 355000          | <b>GX45F</b>         | 2.25                    |
| 50                   | 130 | 42.5 | 6                         | 275000             | 440000          | <b>GX50F</b>         | 3.15                    |
| 60                   | 150 | 45   | 6                         | 375000             | 600000          | <b>GX60F</b>         | 4.65                    |
| 70                   | 160 | 50   | 5                         | 4750000            | 750000          | <b>GX70F</b>         | 5.40                    |
| 80                   | 180 | 50   | 5                         | 570000             | 915000          | <b>GX80F</b>         | 6.95                    |
| 100                  | 210 | 59   | 5                         | 735000             | 1180000         | <b>GX100F</b>        | 11.0                    |
| 120                  | 230 | 64   | 4                         | 880000             | 1430000         | <b>GX120F</b>        | 14.0                    |