

Inch-size steel-on-steel spherical plain bearing

Series **GEZ..ES**

GEZ..ES-2R

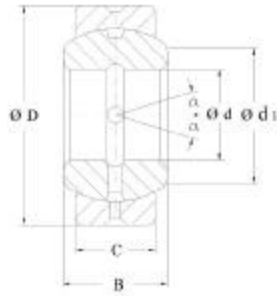

GEZ...ES

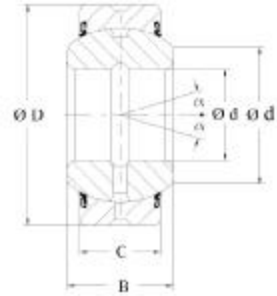

GEZ...ES-2RS

Code bearing	Principal dimensions					Basic load ratings			α	Mass
	d	D	B	C	d1min	dyn	stat	≈		
HMEC	mm									kg
GEZ12ES	12.7	22.225	11.1	9.525	14.1	13.7	41.5	6	0.022	
GEZ15ES	15.875	26.988	13.894	11.913	18.3	22.0	65.5	6	0.036	
GEZ19ES	19.05	31.75	16.662	14.275	21.8	31.5	95.0	6	0.053	
GEZ22ES	22.225	36.513	19.431	16.662	25.4	42.5	127	6	0.085	
GEZ25ES GEZ25ES-2RS	25.4	41.275	22.225	19.05	27.6	56.0	166	6	0.121	
GEZ31ES GEZ31ES-2RS	31.75	50.8	27.762	23.8	36.0	86.5	260	6	0.232	
GEZ34ES GEZ34ES-2RS	34.925	55.563	30.15	26.187	38.6	102	310	6	0.351	
GEZ38ES GEZ38ES-2RS	38.1	61.913	33.325	28.575	41.2	125	375	6	0.422	
GEZ44ES GEZ44ES-2RS	44.45	71.438	38.887	33.325	50.7	170	510	6	0.641	
GEZ50ES GEZ50ES-2RS	50.8	80.963	44.45	38.1	57.9	224	670	6	0.932	
GEZ57ES GEZ57ES-2RS	57.15	90.488	50.013	42.85	64.9	280	850	6	1.33	
GEZ63ES GEZ63ES-2RS	63.5	100.013	55.55	47.625	73.3	355	1060	6	1.85	
GEZ69ES GEZ69ES-2RS	69.85	111.125	61.112	52.375	79.1	415	1250	6	2.42	
GEZ76ES GEZ76ES-2RS	76.2	120.65	66.675	57.15	86.8	500	1500	6	3.10	
GEZ82ES GEZ82ES-2RS	82.55	130.175	72.238	61.9	94.5	585	1760	6	3.82	
GEZ88ES GEZ88ES-2RS	88.9	139.7	77.775	66.675	101.6	680	2040	6	4.79	
GEZ95ES GEZ95ES-2RS	95.25	149.225	83.337	71.425	108.7	780	2360	6	5.78	
GEZ101ES GEZ101ES-2RS	101.6	158.75	88.9	76.2	115.8	900	2650	6	6.99	
GEZ107ES GEZ107ES-2RS	107.95	168.275	94.463	80.95	122.8	1000	3000	6	8.41	
GEZ114ES GEZ114ES-2RS	114.3	177.8	100.013	85.725	130.6	1120	3400	6	9.79	
GEZ120ES GEZ120ES-2RS	120.65	187.325	105.562	90.475	137.6	1250	3750	6	11.5	
GEZ127ES GEZ127ES-2RS	127	196.85	111.125	95.25	145.3	1400	4150	6	13.5	
GEZ152ES GEZ152ES-2RS	152.4	222.25	120.65	104.775	168.2	1730	5200	6	17.5	