

# Linear Motion Ball Bearing

Series LME...UU  
LME...AJ  
LME...OP

HMEC

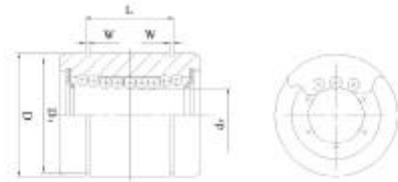

LME...UU

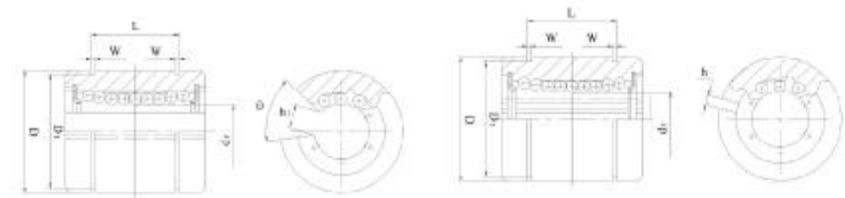

LME...AJ

LME...OP

Code bearing		Major dimensions and tolerance					
HMEC				dr	Tolerance		
LME...UU	Ball circuit	Weight g	LME...AJ	LME...OP	mm	Precision J	Precision P
LME4UU	4	1.9			4	-	+8~-0
LME5UU	4	11	LME 5-AJ		5	-	+8~-0
LME8UU	4	20	LME 8-AJ		8	-	+8~-0
LME10UU	4	29.5	LME 10-AJ	LME 10-OP	10	-	+8~-0
LME12UU	4	41	LME 12-AJ	LME 12-OP	12	-	+8~-0
LME16UU	5	57	LME 16-AJ	LME 16-OP	16	-	+9~-0
LME20UU	5	91	LME 20-AJ	LME 20-OP	20	-	+9~-0
LME25UU	5	215	LME 25-AJ	LME 25-OP	25	-	+11~-1
LME30UU	6	325	LME 30-AJ	LME 30-OP	30	-	+11~-1
LME40UU	6	705	LME 40-AJ	LME 40-OP	40	-	+13~-2
LME50UU	6	1130	LME 50-AJ	LME 50-OP	50	-	+13~-2
LME60UU	6	2050	LME 80-AJ	LME 80-OP	60	-	+13~-2

Major dimensions and tolerance											Um <sub>max</sub>		Load ratings	
D	tolerance	L	tolerance	B	tolerance	W	D1	h	h <sub>1</sub>	θ	J	P	dyn. C	stat. Co
mm											mm			
8	0~-8	12	0~-120	---	---	---	---	---	---	---	12	88	127	
12	0~-8	22	0~-200	14.5	---	1.1	11.5	1	---	---	12	206	265	
16	0~-8	25	0~-200	16.5	0~-200	1.1	15.2	1	---	---	12	265	402	
19	0~-9	29	0~-200	22	0~-200	1.3	18	1	6.8	80°	12	372	549	
22	0~-9	32	0~-200	22.9	0~-200	1.3	21	1.5	7.5	78°	12	510	784	
26	0~-9	36	0~-200	24.9	0~-200	1.3	24.9	1.5	10	78°	12	578	892	
32	0~-11	45	0~-200	31.5	0~-200	1.6	30.3	2	10	60°	15	862	1370	
40	0~-11	58	0~-300	44.1	0~-300	1.85	37.5	2	12.5	60°	15	980	1570	
47	0~-11	68	0~-300	52.1	0~-300	1.85	44.5	2	12.5	50°	15	1570	2740	
62	0~-13	80	0~-300	60.6	0~-300	2.15	59	3	16.8	50°	17	2160	4020	
75	0~-13	100	0~-300	77.6	0~-300	2.65	72	3	21	50°	17	3820	7940	
90	0~-15	125	0~-400	101.7	0~-400	3.15	86.5	3	27.2	54°	20	4700	9800	