

**Needle roller / axial cylindrical roller bearings
suitable for flanged mounting**

Series **ZARF**
ZARF...L
heavy series

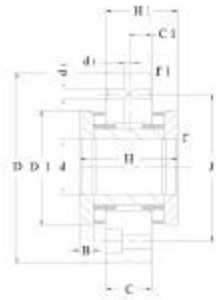

ZARF

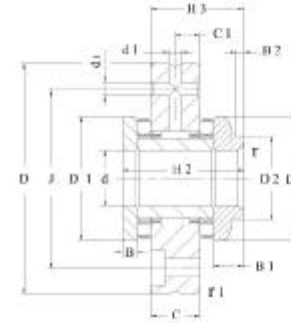

ZARF...L

HMEC

Shaft diameter	Dimensions							Basic Load rating	
	d	D	B	D ₁	D ₂	r	r ₁	dyn. C	stat. C ₀
	-0.005 ⁵⁾	-0.010 ⁶⁾	-0.25			min	min	kN	
20	20	80	12.5	52	-	0.3	0.6	22.6	36
	20	80	12.5	52	40	0.3	0.6	22.6	36
25	25	90	12.5	62	-	0.3	0.6	24.3	41.5
	25	90	12.5	62	48	0.3	0.6	24.3	41.5
30	30	105	14	68	-	0.3	0.6	26	47
	30	105	14	68	52	0.3	0.6	26	47
35	35	110	14	73	-	0.3	0.6	27.5	53
	35	110	14	73	60	0.3	0.6	27.5	53
40	40	115	16	78	-	0.3	0.6	38	74
	40	115	16	78	60	0.3	0.6	38	74
45	45	130	17.5	90	-	0.3	0.6	40	82
	45	130	17.5	90	70	0.3	0.6	40	82
50	50	140	17.5	95	-	0.3	0.6	42	90
	50	140	17.5	95	75	0.3	0.6	42	90
55	55	145	17.5	100	-	0.3	0.6	44	98
	55	145	17.5	100	80	0.3	0.6	44	98
60	60	150	17.5	105	-	0.3	0.6	44.5	92
	60	150	17.5	105	90	0.3	0.6	44.5	92
65	65	155	17.5	110	-	0.3	0.6	54	104
	65	155	17.5	110	90	0.3	0.6	54	104
70	70	160	17.5	115	-	0.3	0.6	56	119
	70	160	17.5	115	100	0.3	0.6	56	119
75	75	185	21	135	-	0.3	1	75	139
	75	185	21	135	115	0.3	1	75	139
90	90	210	22.5	160	-	0.3	1	101	218
	90	210	22.5	160	130	0.3	1	101	218

Limiting speed	Bearing frictional torque	Axial rigidity	Tilting rigidity	Code bearing	Mass
n _G grease	M _{RL}	C _{aL}	C _{kL}	HMEC	≈
min ⁻¹	Nm	N/um	Nm/mrad		kg
1500	1.3	2300	400	ZARF 2080 TN	1.1
1500	1.3	2300	400	ZARF 2080 LTN	1.22
1400	1.6	3000	800	ZARF 2590 TN	1.6
1400	1.6	3000	800	ZARF 2590 LTN	1.75
1300	2.1	3300	1100	ZARF 30105 TN	1.95
1300	2.1	3300	1100	ZARF 30105 LTN	2.15
1250	2.3	3500	1300	ZARF 35110 TN	1.6
1250	2.3	3500	1300	ZARF 35110 LTN	1.85
1200	2.5	3800	1800	ZARF 40115 TN	2.7
1200	2.5	3800	1800	ZARF 40115 LTN	3
1150	3.5	4000	2100	ZARF 45130 TN	3.9
1150	3.5	4000	2100	ZARF 45130 LTN	4.3
1100	3.8	4600	2900	ZARF 50140 TN	4.2
1100	3.8	4600	2900	ZARF 50140 LTN	4.65
1000	4	4900	3600	ZARF 55145 TN	4.5
1000	4	4900	3600	ZARF 55145 LTN	5
950	4.2	5300	4300	ZARF 60150 TN	4.7
950	4.2	5300	4300	ZARF 60150 LTN	5.35
900	4	4800	4000	ZARF 65155 TN	5.1
900	4	4800	4000	ZARF 65155 LTN	5.7
800	4.8	5800	6000	ZARF 70160 TN	5.2
800	4.8	5800	6000	ZARF 70160 LTN	5.95
700	8	6600	8500	ZARF 75185 TN	9.4
700	8	6600	8500	ZARF 75185 LTN	10.6
700	10.5	7700	14500	ZARF 90210 TN	13.7
700	10.5	7700	14500	ZARF 90210 LTN	15.1