

**Needle roller / axial cylindrical roller bearings
suitable for flanged mounting**

Series **ZARF**
ZARF...L
light series

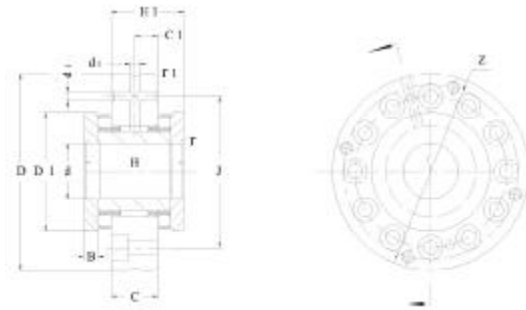

ZARF

Shaft diameter	Dimensions															
	d	D	H	H ₁	H ₂	H ₃	C	D ₁	D ₂	D ₃	B	B ₁	B ₂	r	r ₁	J
	-0.005 ⁵⁾	-0.010 ⁶⁾											-0.25	min	min	
15	15	60	40	26	-	-	14	35	-	-	7.5	-	-	0.3	0.6	46
	15	60	-	-	53	39	14	35	24	34	7.5	20.5	11	0.3	0.6	46
17	17	62	43	27.5	-	-	14	38	-	-	9	-	-	0.3	0.6	48
	17	62	-	-	57	41.5	14	38	28	38	9	23	11	0.3	0.6	48
20	20	68	46	29	-	-	14	42	-	-	10	-	-	0.3	0.6	53
	20	68	-	-	60	43	14	42	30	40	10	24	11	0.3	0.6	53
25	25	75	50	33	-	-	18	47	-	-	10	-	-	0.3	0.6	58
	25	75	-	-	65	48	18	47	36	45	10	25	11	0.3	0.6	58
30	30	80	50	33	-	-	18	52	-	-	10	-	-	0.3	0.6	63
	30	80	-	-	65	48	18	52	40	50	10	25	11	0.3	0.6	63
35	35	90	54	35	-	-	18	60	-	-	11	-	-	0.3	0.6	73
	35	90	-	-	70	51	18	60	45	58	11	27	12	0.3	0.6	73
40	40	100	54	35	-	-	18	62	-	-	11	-	-	0.3	0.6	80
	40	100	-	-	70	51	18	62	50	63	11	27	12	0.3	0.6	80
45	45	105	60	40	-	-	22.5	70	-	-	11.5	-	-	0.3	0.6	85
	45	105	-	-	75	55	22.5	70	56	68	11.5	26.5	12	0.3	0.6	85
50	50	115	60	40	-	-	22.5	78	-	-	11.5	-	-	0.3	0.6	90
	50	115	-	-	78	58	22.5	78	60	78	11.5	26.5	12	0.3	0.6	90

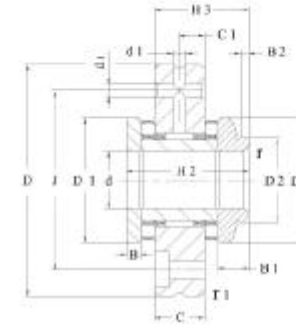

ZARF...L

Basic Load rating				Limiting speed n _{G grease}	Bearing frictional torque M _{RL}	Axial rigidity C _{aL}	Tilting rigidity C _{kL}	Code bearing HMEC	Mass ≈
axial dyn. C	stat. Co	radial dyn. C	stat. Co						
kN		kN		min ⁻¹	Nm	N/um	Nm/mrad		kg
24.9	53	13	17.5	2200	0.35	1400	110	ZARF 1560 TN	0.42
24.9	53	13	17.5	2200	0.35	1400	110	ZARF 1560 LTN	0.45
26	57	14	19.9	2100	0.4	1600	160	ZARF 1762 TN	0.49
26	57	14	19.9	2100	0.4	1600	160	ZARF 1762 LTN	0.52
33.5	76	14.9	22.4	2000	0.5	1800	230	ZARF 2068 TN	0.56
33.5	76	14.9	22.4	2000	0.5	1800	230	ZARF 2068 LTN	0.61
35.5	86	22.6	36	1900	0.55	1900	350	ZARF 2575 TN	0.78
35.5	86	22.6	36	1900	0.55	1900	350	ZARF 2575 LTN	0.84
39	101	24.3	41.5	1800	0.65	2200	520	ZARF 3080 TN	0.85
39	101	24.3	41.5	1800	0.65	2200	520	ZARF 3080 LTN	0.9
56	148	26	47	1700	0.9	2600	740	ZARF 3590 TN	1.12
56	148	26	47	1700	0.9	2600	740	ZARF 3590 LTN	1.25
59	163	27.5	53	1600	1	2800	1030	ZARF 40100 TN	1.35
59	163	27.5	53	1600	1	2800	1030	ZARF 40100 LTN	1.45
61	177	38	74	1500	1.2	3000	1340	ZARF 45105 TN	1.7
61	177	38	74	1500	1.2	3000	1340	ZARF 45105 LTN	1.85
90	300	40	82	1200	2.2	4800	2470	ZARF 50115 TN	2.1
90	300	40	82	1200	2.2	4800	2470	ZARF 50115 LTN	2.45

HMEC