

Needle roller / axial cylindrical roller bearings

Series ZARN
ZARN...L
heavy series

HMEC

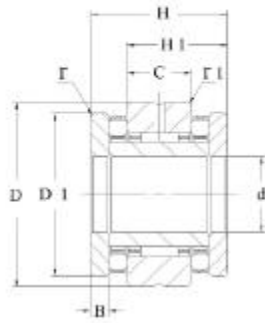

ZARN

Shaft diameter	Dimensions							Basic Load rating	
	d	D	B	D ₁	D ₂	r	r ₁	dyn. C	stat. C ₀
	-0.005 ⁵⁾	-0.010 ⁶⁾	-0.25			min	min	kN	
20	20	62	12.5	52	-	0.3	0.6	22.6	36
	20	62	12.5	52	40	0.3	0.6	22.6	36
25	25	72	12.5	62	-	0.3	0.6	24.3	41.5
	25	72	12.5	62	48	0.3	0.6	24.3	41.5
30	30	80	14	68	-	0.3	0.6	26	47
	30	80	14	68	52	0.3	0.6	26	47
35	35	85	14	73	-	0.3	0.6	27.5	53
	35	85	14	73	60	0.3	0.6	27.5	53
40	40	90	16	78	-	0.3	0.6	38	74
	40	90	16	78	60	0.3	0.6	38	74
45	45	105	17.5	90	-	0.3	0.6	40	82
	45	105	17.5	90	70	0.3	0.6	40	82
50	50	110	17.5	95	-	0.3	0.6	42	90
	50	110	17.5	95	75	0.3	0.6	42	90
55	55	115	17.5	100	-	0.3	0.6	44	98
	55	115	17.5	100	80	0.3	0.6	44	98
60	60	120	17.5	105	-	0.3	0.6	44.5	92
	60	120	17.5	105	90	0.3	0.6	44.5	92
65	65	125	17.5	110	-	0.3	0.6	54	104
	65	125	17.5	110	90	0.3	0.6	54	104
70	70	130	17.5	115	-	0.3	0.6	56	119
	70	130	17.5	115	100	0.3	0.6	56	119
75	75	155	21	135	-	0.3	1	75	139
	75	155	21	135	115	0.3	1	75	139
90	90	180	22.5	160	-	0.3	1	101	218
	90	180	22.5	160	130	0.3	1	101	218

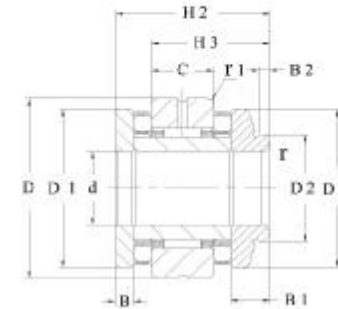

ZARN...L

Limiting speed	Bearing frictional torque	Axial rigidity	Tilting rigidity	Code bearing	Mass
n _G grease	M _{RL}	C _{aL}	C _{kL}	HMEC	≈
min ⁻¹	Nm	N/um	Nm/mrad		kg
1500	1.3	2300	400	ZARN 2062 TN	0.87
1500	1.3	2300	400	ZARN 2062 LTN	0.99
1400	1.6	3000	800	ZARN 2572 TN	1.17
1400	1.6	3000	800	ZARN 2572 LTN	1.32
1300	2.1	3300	1100	ZARN 3080 TN	1.5
1300	2.1	3300	1100	ZARN 3080 LTN	1.7
1250	2.3	3500	1300	ZARN 3585 TN	1.65
1250	2.3	3500	1300	ZARN 3585 LTN	1.8
1200	2.5	3800	1800	ZARN 4090 TN	2.09
1200	2.5	3800	1800	ZARN 4090 LTN	2.39
1150	3.5	4000	2100	ZARN 45105 TN	3.02
1150	3.5	4000	2100	ZARN 45105 LTN	3.42
1100	3.8	4600	2900	ZARN 50110 TN	3.3
1100	3.8	4600	2900	ZARN 50110 LTN	3.75
1000	4	4900	3600	ZARN 55115 TN	3.5
1000	4	4900	3600	ZARN 55115 LTN	4
950	4.2	5300	4300	ZARN 60120 TN	3.7
950	4.2	5300	4300	ZARN 60120 LTN	4.85
900	4	4800	4000	ZARN 60125 TN	4
900	4	4800	4000	ZARN 60125 LTN	4.6
800	4.8	5800	6000	ZARN 70130 TN	4.1
800	4.8	5800	6000	ZARN 70130 LTN	4.85
700	8	6600	8500	ZARN 75155 TN	7.9
700	8	6600	8500	ZARN 75155 LTN	9.1
700	10.5	7700	14500	ZARN 90180 TN	11.8
700	10.5	7700	14500	ZARN 90180 LTN	13.2