

Needle roller / axial cylindrical roller bearings

Series ZARN
ZARN...L
light series

HMEC

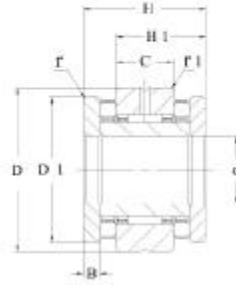

ZARN

Shaft diameter	Dimensions														
	d	D	H	H ₁	H ₂	H ₃	C	D ₁	D ₂	D ₃	B	B ₁	B ₂	r	r ₁
														min	min
15	15	45	40	28	-	-	16	35	-	-	7.5	-	-	0.3	0.6
	15	45	-	-	53	41	16	35	24	34	7.5	20.5	11	0.3	0.6
17	17	47	43	29.5	-	-	16	38	-	-	9	-	-	0.3	0.6
	17	47	-	-	57	43.5	16	38	28	38	9	23	11	0.3	0.6
20	20	52	46	31	-	-	16	42	-	-	10	-	-	0.3	0.6
	20	52	-	-	60	45	16	42	30	40	10	24	11	0.3	0.6
25	25	57	50	35	-	-	20	47	-	-	10	-	-	0.3	0.6
	25	57	-	-	65	50	20	47	36	45	10	25	11	0.3	0.6
30	30	62	50	35	-	-	20	52	-	-	10	-	-	0.3	0.6
	30	62	-	-	65	50	20	52	40	50	10	25	11	0.3	0.6
35	35	70	54	37	-	-	20	60	-	-	11	-	-	0.3	0.6
	35	70	-	-	70	53	20	60	45	58	11	27	12	0.3	0.6
40	40	75	54	37	-	-	20	65	-	-	11	-	-	0.3	0.6
	40	75	-	-	70	53	20	65	50	63	11	27	12	0.3	0.6
45	45	80	60	42.5	-	-	25	70	-	-	11.5	-	-	0.3	0.6
	45	80	-	-	75	57.5	25	70	56	68	11.5	26.5	12	0.3	0.6
50	50	90	60	42.5	-	-	25	78	-	-	11.5	-	-	0.3	0.6
	50	90	-	-	78	60.5	25	78	60	78	11.5	29.5	12	0.3	0.6

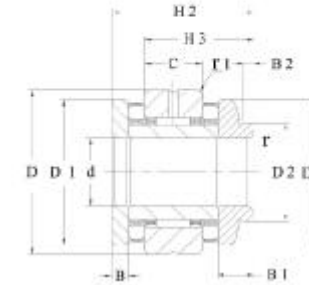

ZARN...L

Basic Load rating				Limiting speed n_G grease min ⁻¹	Bearing frictional torque M_{RL} Nm	Axial rigidity C_{aL} N/um	Tilting rigidity C_{kL} Nm/mrad	Code bearing HMEC	Mass ≈ kg
axial dyn. C	stat. Co	radial dyn. C	stat. Co						
24.9	53	13	17.5	2200	0.35	1400	110	ZARN 1545 TN	0.34
24.9	53	13	17.5	2200	0.35	1400	110	ZARN 1545 LTN	0.37
26	57	14	19.9	2100	0.4	1600	160	ZARN 1747 TN	0.37
26	57	14	19.9	2100	0.4	1600	160	ZARN 1747 LTN	0.41
33.5	76	14.9	22.4	2000	0.5	1800	230	ZARN 2052 TN	0.41
33.5	76	14.9	22.4	2000	0.5	1800	230	ZARN 2052 LTN	0.46
33.5	86	22.6	36	1900	0.55	1900	350	ZARN 2557 TN	0.53
33.5	86	22.6	36	1900	0.55	1900	350	ZARN 2557 LTN	0.59
39	101	24.3	41.5	1800	0.65	2200	520	ZARN 3062 TN	0.6
39	101	24.3	41.5	1800	0.65	2200	520	ZARN 3062 LTN	0.75
56	148	26	47	1700	0.9	2600	740	ZARN 3570 TN	0.8
56	148	26	47	1700	0.9	2600	740	ZARN 3570 LTN	0.93
59	163	27.5	53	1600	1	2800	1030	ZARN 4075 TN	0.9
59	163	27.5	53	1600	1	2800	1030	ZARN 4075 LTN	1
61	177	38	74	1500	1.2	3000	1340	ZARN 4580 TN	1.12
61	177	38	74	1500	1.2	3000	1340	ZARN 4580 LTN	1.27
90	300	40	82	1200	2.2	4800	2470	ZARN 5090 TN	1.43
90	300	40	82	1200	2.2	4800	2470	ZARN 5090 LTN	1.78