

**Deep groove ball bearings
(imperial sizes)**

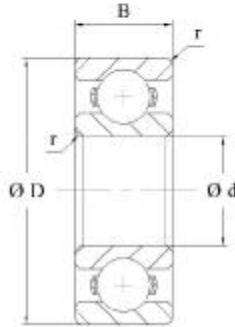

Shaft	Dimensions			Load rating		Limiting speed		Code bearing	Mass
	d	D	B	dyn. C	stat. Co			HMEC	≈
	mm			KN		Grease	oil		kg
	15.875	39.688	11.112	7.34	4.74	17000	20000	RLS5	0.064
	19.05	47.625	14.288	9.88	6.65	15000	18000	RLS6	0.12
	22.225	50.80	14.288	11.67	7.94	14000	17000	RLS7	0.13
	25.4	57.15	15.875	12.78	9.44	11000	14000	RLS8	0.17
	28.575	63.5	15.875	14.96	11.31	10000	13000	RLS9	0.23
	31.75	69.85	17.462	13.64	11.2	9500	12000	RLS10	0.30
	34.925	76.2	17.462	19.77	15.59	9000	11000	RLS11	0.35
	38.1	82.55	19.05	25.09	19.84	8500	10000	RLS12	0.41
	15.875	46.038	15.875	8.87	5.51	16000	19000	RMS5	0.13
	19.05	50.8	17.462	12.26	7.88	13000	16000	RMS6	0.16
	22.225	57.15	17.462	15.97	10.5 1	2000	15000	RMS7	0.19
	25.4	63.5	19.05	17.3	11.51	12000	14000	RMS8	0.26
	28.575	71.438	20.638	21.73	15.82	9000	11000	RMS9	0.37
	31.75	79.375	22.225	25.75	18.33	8500	10000	RMS10	0.44
	34.925	88.9	22.225	31.35	24.01	7500	9000	RMS11	0.61
	38.1	95.25	23.812	35	25.4	7500	9000	RMS12	0.77