

**Deep groove ball bearings
(imperial sizes)**

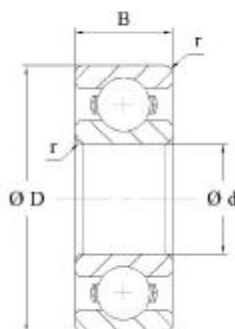

Dimensions			Load rating		Code bearing
d	D	B	dyn. C	stat. Co	HMEC
mm			kN		
3.175	9.525	3.969	0.64	0.22	R2
3.175	12.7	4.366	1.15	0.395	R2A
4.726	12.7	3.969	1.07	0.42	R3
6.35	15.875	4.978	1.47	0.6	R4
6.35	19.05	5.556	2.8	1.06	R4A
9.525	22.225	5.556	3.33	1.41	R6
12.7	28.575	6.35	5.11	2.38	R8
15.875	34.925	7.144	6.00	3.25	R10
19.05	41.275	7.938	9.37	5.02	R12
22.225	47.625	9.525	10.06	5.92	R14
25.4	50.8	9.525	14.02	7.93	R16
28.575	56.261	9.525	10.18	6.91	R18
31.75	57.15	9.525	10.71	7.53	R20
34.925	63.5	11.112	12.47	8.66	R22
38.1	66.675	11.112	12.47	8.66	R24
2.381	4.763	1.59	0.98	0.036	R133
3.175	6.350	2.38	0.156	0.058	R144
3.969	7.938	2.799	0.187	0.08	R155
4.762	7.938	2.779	0.187	0.08	R156
4.762	9.525	3.175	0.36	0.147	R166
6.35	9.525	3.175	0.187	0.089	R168
4.762	12.7	2.779	0.64	0.345	R186
6.35	12.7	3.175	0.55	0.25	R188
7.938	12.7	3.969	0.276	0.138	R1810
15.875	34.925	7.94	5.868	3.214	99502H
4.762	17.462	6.35	1.97	0.73	1601
6.35	17.462	6.35	1.97	0.73	1602
7.938	22.225	7.144	3.29	1.36	1603
9.525	22.225	7.144	3.33	1.41	1604
7.938	23.019	7.938	3.33	1.41	1605