

HMEC

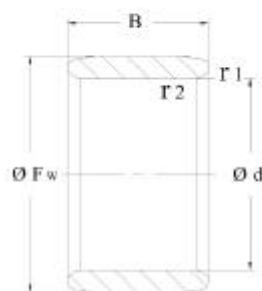

IR

Shaft diameter	Dimensions				Code bearing	Weight
	d	D	B	r ₁ , r ₂ min	HMEC	≈ kg
130	130	145	35	1.1	IR 130x145x35	0.855
	130	150	50	1.5	IR 130x150x50	1.69
140	140	155	35	1.1	IR 140x155x35	0.92
	140	160	40	1.1	IR 140x160x50	1.80
150	150	165	40	1.1	IR 150x165x40	1.12
160	160	175	40	1.1	IR 160x175x40	1.20
170	170	185	45	1.1	IR 170x185x45	1.45
180	180	195	45	1.1	IR 180x195x45	1.50
190	190	210	50	1.5	IR 190x210x50	2.41
200	200	220	50	1.5	IR 200x220x50	2.49
220	220	240	50	1.5	IR 220x240x50	2.75
240	240	265	60	2	IR 240x265x60	4.60