

Cylindrical Roller Thrust Bearings

series 811..

K 81100

WS 811..

GS 811..

HMEC

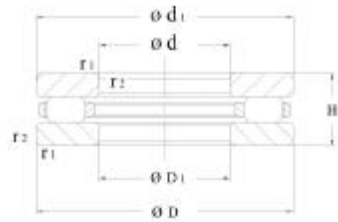

811..

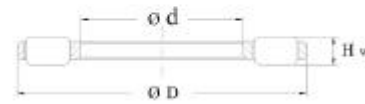

K 811..

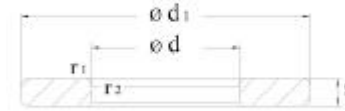

WS 811..



GS 811..

Shaft diameter	Dimensions								Load ratings	
	d	D	H	d	d ₁	D ₁	S	r _{1/2} min	dyn. Ca	stat. Coa
	mm									
kN										
70	70	95	18	70	95	72	5.25	1	71	265
	70	105	27	70	105	72	8	1	122	440
75	75	100	19	75	100	77	5.75	1	75	285
	75	110	27	75	110	77	8	1	125	440
80	80	105	19	80	105	82	5.75	1	76.5	300
	80	115	28	80	115	82	8.5	1	129	455
85	85	110	19	85	110	87	5.75	1	76.5	310
	85	125	31	85	125	88	9.5	1	153	550
90	90	120	22	90	120	92	6.5	1	104	415
	90	135	35	90	135	93	10.5	1.1	190	670
100	100	135	25	100	135	102	7	1	146	585
	100	150	38	100	150	103	11.5	1.1	224	815
110	110	145	25	110	145	112	7	1	160	655
	110	160	38	110	160	113	11.5	1.1	232	865
120	120	155	25	120	155	122	7	1	160	680
	120	170	39	120	170	123	12	1.1	245	950

Speed rating		Code bearing	Cylindrical Roller and Cage thrust assembly	Shaft Washer	Housing Washer	Mass
ng grease	ng oil					
HMEC						
≈						
kg						
1000	3200	81114	K81114	WS81114	GS81114	0.36
950	3000	81214	K81214	WS81214	GS81214	0.87
950	3000	81115	K81115	WS81115	GS81115	0.43
900	2800	81215	K81215	WS81215	GS81215	0.92
900	2800	81116	K81116	WS81116	GS81116	0.46
850	2600	81216	K81216	WS81216	GS81216	1.02
850	2600	81117	K81117	WS81117	GS81117	0.48
800	2400	81217	K81217	WS81217	GS81217	1.36
800	2400	81118	K81118	WS81118	GS81118	0.72
800	2400	81218	K81218	WS81218	GS81218	1.85
750	2200	81120	K81120	WS81120	GS81120	1.07
700	2000	81220	K81220	WS81220	GS81220	2.45
700	2000	81122	K81122	WS81122	GS81122	1.12
670	1900	81222	K81222	WS81222	GS81222	2.70
670	1900	81124	K81124	WS81124	GS81124	1.25
630	1800	81224	K81224	WS81224	GS81224	2.98