

Cylindrical Roller Thrust Bearings

series 811..

K 81100

WS 811..

GS 811..

HMEC

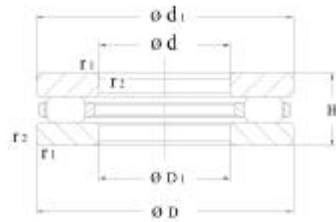

811..

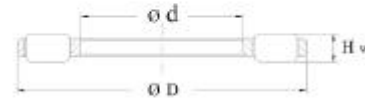

K 811..

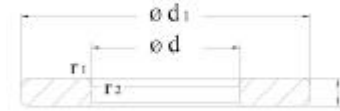

WS 811..



GS 811..

| Shaft diameter | Dimensions | | | | | | | | Load ratings | |
|----------------|------------|-----|----|----|----------------|----------------|------|-------------------------|--------------|-----------|
| | d | D | H | d | d ₁ | D ₁ | S | r _{1/2} min | dyn. Ca | stat. Coa |
| | mm | | | | | | | | | |
| 30 | 30 | 47 | 11 | 30 | 47 | 32 | 3 | 0.6 | 28 | 83 |
| | 30 | 52 | 16 | 30 | 52 | 32 | 4.25 | 0.6 | 50 | 132 |
| 35 | 35 | 52 | 12 | 35 | 52 | 37 | 3.5 | 0.6 | 30 | 93 |
| | 35 | 62 | 18 | 35 | 62 | 37 | 5.25 | 1 | 54 | 156 |
| 40 | 40 | 60 | 13 | 40 | 60 | 42 | 3.5 | 0.6 | 42.5 | 137 |
| | 40 | 68 | 19 | 40 | 68 | 42 | 5 | 1 | 76.5 | 220 |
| 45 | 45 | 65 | 14 | 45 | 65 | 47 | 4 | 0.6 | 45 | 150 |
| | 45 | 73 | 20 | 45 | 73 | 47 | 5.5 | 1 | 83 | 255 |
| 50 | 50 | 70 | 14 | 50 | 70 | 52 | 4 | 0.6 | 42.5 | 143 |
| | 50 | 78 | 22 | 50 | 78 | 52 | 6.5 | 1 | 88 | 285 |
| 55 | 55 | 78 | 16 | 55 | 78 | 57 | 5 | 0.6 | 52 | 193 |
| | 55 | 90 | 25 | 55 | 90 | 57 | 7 | 1 | 122 | 390 |
| 60 | 60 | 85 | 17 | 60 | 85 | 62 | 4.75 | 1 | 73.5 | 265 |
| | 60 | 95 | 26 | 60 | 95 | 62 | 7.5 | 1 | 114 | 365 |
| 65 | 65 | 90 | 18 | 65 | 90 | 67 | 5.25 | 1 | 76.5 | 285 |
| | 65 | 100 | 27 | 65 | 100 | 67 | 8 | 1 | 118 | 390 |

| Speed rating | | Code bearing | Cylindrical Roller and Cage thrust assembly | Shaft Washer | Housing Washer | Mass |
|--------------|--------|--------------|---|----------------|----------------|------|
| ng grease | ng oil | | | | | |
| 2600 | 6700 | 81106 | K81106 | WS81106 | GS81106 | 0.06 |
| 2400 | 6300 | 81206 | K81206 | WS81206 | GS81206 | 0.13 |
| 2200 | 6000 | 81107 | K81107 | WS81107 | GS81107 | 0.08 |
| 1900 | 5300 | 81207 | K81207 | WS81207 | GS81207 | 0.23 |
| 1900 | 5300 | 81108 | K81108 | WS81108 | GS81108 | 0.12 |
| 1700 | 4800 | 81208 | K81208 | WS81208 | GS81208 | 0.27 |
| 1700 | 4800 | 81109 | K81109 | WS81109 | GS81109 | 0.14 |
| 1600 | 4500 | 81209 | K81209 | WS81209 | GS81209 | 0.31 |
| 1500 | 4300 | 81110 | K81110 | WS81110 | GS81110 | 0.16 |
| 1400 | 4000 | 81210 | K81210 | WS81210 | GS81210 | 0.38 |
| 1400 | 4000 | 81111 | K81111 | WS81111 | GS81111 | 0.23 |
| 1200 | 3600 | 81211 | K81211 | WS81211 | GS81211 | 0.60 |
| 1200 | 3600 | 81112 | K81112 | WS81112 | GS81112 | 0.28 |
| 1100 | 3400 | 81212 | K81212 | WS81212 | GS81212 | 0.74 |
| 1100 | 3400 | 81113 | K81113 | WS81113 | GS81113 | 0.33 |
| 950 | 3000 | 81213 | K81213 | WS81213 | GS81213 | 0.82 |